

HPS POWER SUPPLY

Short Circuit Protection

Over Load Protection

Rail Mounting

Aesthetic Design

Constant Current Output

HPS240



HPS240

240W 24VDC Dual Output Rail Mount Power Supply

T: +90 (216) 668 00 06

www.gmtcontrol.com

GMT Endüstriyel Elektronik San. ve Tic. A.Ş.





Always read the operating instructions before using the device! The user is responsible for any damages, losses and accidents caused by failure to comply with the warnings in the user manual. In case of malfunctions in this case, the device is out of warranty.

Safety Precautions

- The device must be de-energised before making cable connections.
- Wiring must be done in accordance with the wiring diagrams. Otherwise, the power supply will be damaged or cannot perform its function.
- Do not intervene while the power supply is energised.

Dimensions and Mechanical Details (mm)

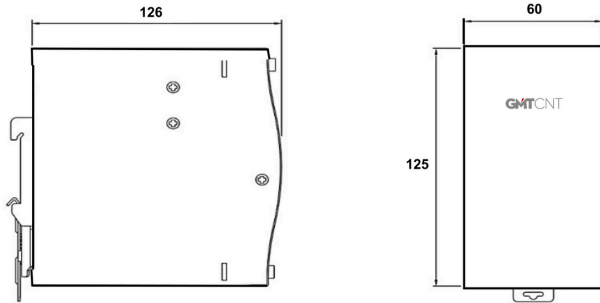

Specifications

Output Specifications	
DC Voltage	24VDC
Nominal Current	10A
Current Range	0-10A
Nominal Power	240W
Ripple and Noise	150mV
Voltage Adjustment Range	-10% ile 15%
Voltage Tolerance	±1%
Installation and Commissioning	1000ms 60ms/230VAC 1800ms 60ms/115VAC at full load
Waiting Time	115 VAC 34ms / 230 VAC 36ms
Input Specifications	
Voltage Range	100 to 240VAC, 90 to 350VDC
AC Current	AC100-220V 5.2A / DC90-350V 2.8A
Productivity	%85
Inrush Current	115VAC 16A / 230VAC 32A
Leakage Current	<1mA 240VAC
Protection	
Overload	120% to 150% of the rated load current
Over Voltage	YWS*5
Environment Conditions	
Operating Temperature and Humidity	Temperature: -25 to 60° Humidity: 20 to 90
Storage Temperature and Humidity	Temperature: -10 to 60° Humidity: 10 to 95
Vibration	Vibration values at 10 to 55 Hz, 0.375 mm single amplitude for 2 hours in each of the X, Y and Z directions. At 10 to 150 Hz, 0.35 mm single amplitude for 80 minutes in each of the X, Y and Z directions (maximum 5 G for 60W, 120W, 240 W)
Security	
Withstand Voltage	I/P-O/P: 3KVAC I/P-FG: 2.0KVAC O/P-FG: 0.5KVAC
Insulation Resistance	I/P-O/P, I/P-FG, O/P-FG: 100M Ohms / 500VDC
Standartlar	
Security Standarts	EN62368-1
EMC Standarts	EN55032,EN55035,EN61000-3-2,EN61000-3-3
Dimensions and Weight	
Dimensions (mm)	125*60*126
Weight	840g

Mounting and Installation

DIN Rail mounting process

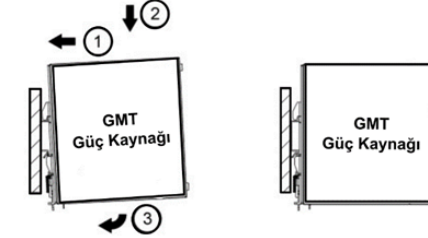

- Tilt the power supply upwards and place it on the DIN rail.
- Press downwards into the rail until it is fully seated in the rail.
- To lock it into the rail, press it against the rail from the front.
- Make sure that the power supply is fully seated on the DIN rail.
Select the DIN rail suitable for the specified width.

DIN Rail disassembly process

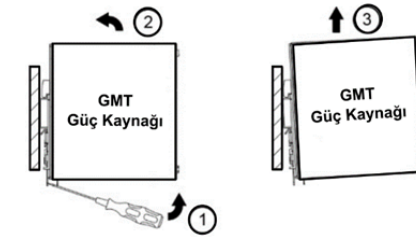

- Slide the DIN rail release latch as shown in the illustration by pressing it downwards with a screwdriver.
- You can remove the power supply from the DIN rail by releasing the latch. *Select the DIN rail suitable for the specified width

Maintenance and Support

Maintenance and repair of the device must be carried out by trained technical personnel. Unauthorised intervention may result in personal injury and/or damage to the device. Please contact our company for the repair of defective devices.

For questions about the device, you can contact us from our contact information below.

GMT Endüstriyel Elektronik San. ve Tic. A.Ş.

Çubuklu Mahallesi Boğaziçi Caddesi No:6/B 34805 Beykoz / İstanbul / Türkiye
T +90 (216) 668 00 06
F +90 (216) 668 00 03
gmt@gmtcontrol.com
www.gmtcontrol.com