

Rated Voltage (Vac)	400
Rated Power (w)	1300
Rated Torque (N.m)	8.34
Peak Torque (N.m)	23.8
Rated Speed (rpm)	1500
Peak Speed (rpm)	4500
Rated Current (Amp)	4.6
Peak Current (Amp)	13.8
Torque Const (N.m/Amp)	1.74
Back EMF Const(V/Krpm)	104.9
Resistance(Ω)	2.26± 5%
Inductance(mH)	23.3± 20%
Inertia (kg*m ² *10 ⁻⁴)	21
Poles	10
Encoder type	23bit optical
IP rating	IP67
Mass (Kg)	8.6
Allowable radial load(N)	686
Allowable thrust load(N)	343

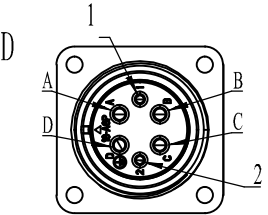

Assignment of power connector with brake						
Pos	A	B	C	D	1	2
Signal	U	V	W	PE	0	24V

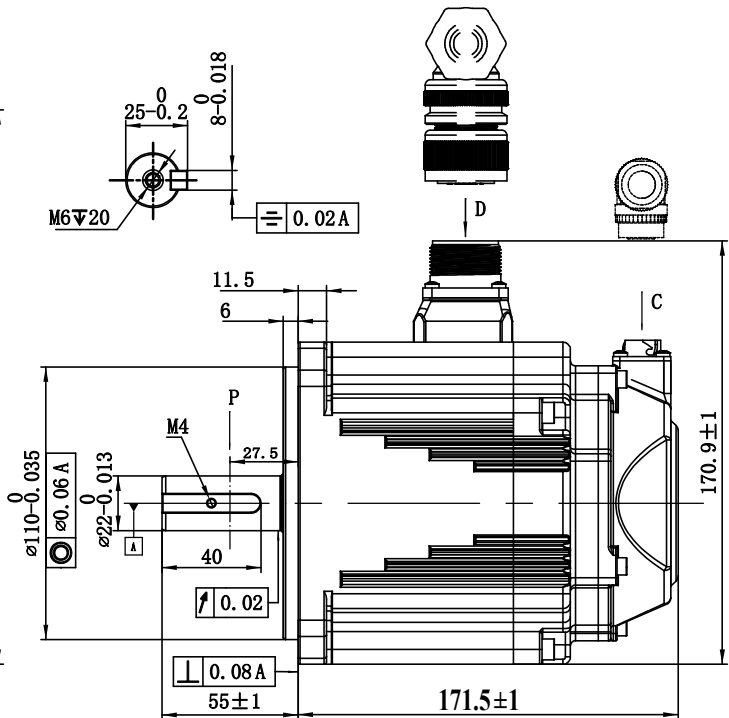
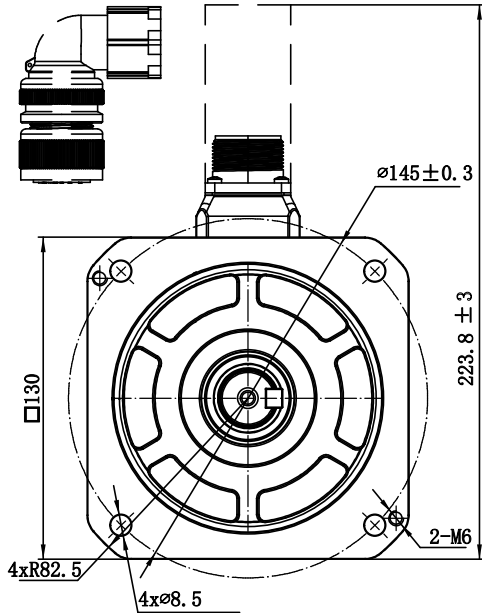
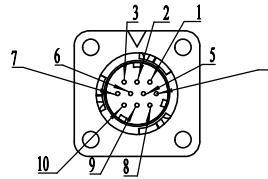

Assignment of encoder connector							
Pos		3	4	5	6	7	10
Signal	5V	0V	SD+	SD-	BAT+	BAT-	PE

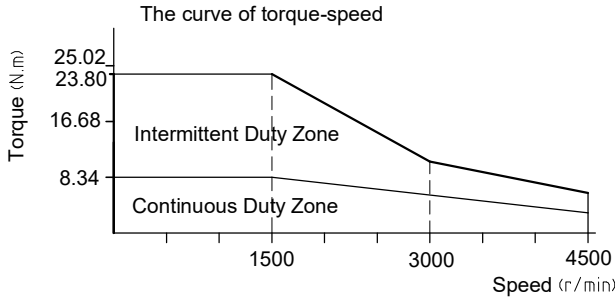

GMTCNT

S2M130F1300B-TS
 130mm, high inertia, 1300W
 23 Bit absolute encoder
 servo motor, with brake